

NOTE: 2"x8" purlins and 1"x8" ties are not necessary over kitchen and library.

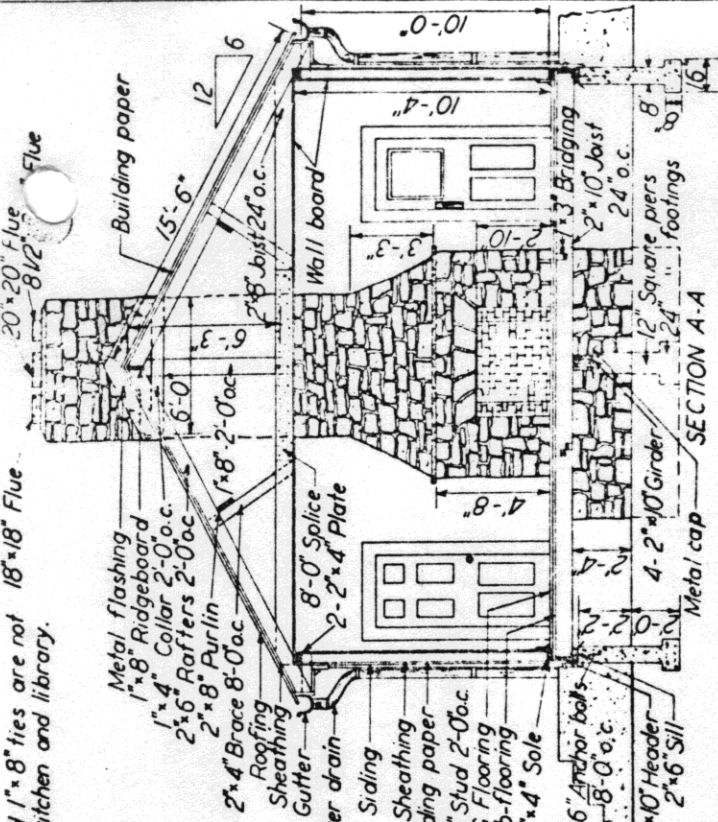

- ### BILL OF MATERIALS
- Corner & trim boards: 440 lin. ft. 1"x4"
 - Bridging: 170 " " " 1"x3"
 - Base board: 170 " " " 1 1/8"x6"
 - Quarter round: 340 " " " "
 - Siding: 1400 sq. ft.
 - Sheathing: 2600 " "
 - Building paper: 2500 " "
 - Roofing: 2700 sq. ft.
 - Wall board: 15 double sash, 210 sq. ft.
 - Windows: 4-3-0 * 7-0
 - Doors: Hardware
 - Gutters: 88'-0" - 5" diam.
 - Leaders: 50'-0" - 3" " 8 elbows
 - Flue lining: 14'-0" - 18" x 18" T. C.
 - 14'-0" - 20" x 20" "
 - 14'-0" - 8 1/2" x 8 1/2" T. C.
 - Ventilators: 6-8" x 12" Metal grate
 - Flashing, Door locks, Nails, Paint, etc. Materials for kitchen and library equipment and electrical equipment not figured.

- Concrete: 1 1/2 4 Mix
- Cement: 107 bags
- Sand: 10.2 cu. yds.
- Stone: 16.2 cu. yds.
- Masonry: 500 cu. ft.
- Stone: 430
- Mortar: 20 bags
- Cement: 2.5 cu. yds.
- Sand: 12 pcs. 2"x6"x12'-0"
- Lumber: 7 "
- Sill: 8 "
- Header: 8 "
- Girder: 8 "
- Floor joist: 48 "
- Sole: 14 "
- Studs: 100 "
- Window sill: 5 "
- Plate: 28 "
- Ceiling joist: 9 "
- Splice: 13 "
- Rafters: 48 "
- Ridgeboard: 4 "
- Collars: 11 "
- Purlin: 4 "
- Rafter brace: 6 "
- Ties: 10 "

- Box cornice material: 8 pcs. 2"x4"x12'-0"
- 20 " 1"x0"x12'-0"
- 90 lin. ft. trim
- 90 " " molding
- Water table: 10 pcs. 1"x8"x14'-0"
- Anchor bolts: 16 - 5/8"x16"

